

TO AIRPORT
BABATPUR ROAD
 TO VARANASI

24.0M WIDE PANCHKOSI ROAD

AREA STATEMENT		
SNO.	PARTICULARS	SQ.MTR./NOS.
1	PERMISSIBLE E.M.S.	14500.4
2	PERMISSIBLE GROUND COVERAGE	50%
3	PERMISSIBLE F.A.R.	2.9%
4	BALANCE F.A.R. FROM E.M.S.	0.88%
5	PERMISSIBLE DENSITY	906
6	PERMISSIBLE HEIGHT	N.A.
7	PERMISSIBLE GREEN AREA	15%
8	NO. OF CAR PARKINGS REQUIRED	360
9	PROPOSED GROUND COVERAGE	21.32%
10	PROPOSED F.A.R. OF HOUSING	2.68%
11	PROPOSED F.A.R. OF COMMERCIAL	0.04%
12	PROPOSED F.A.R. UNDER BALANCE E.M.S. F.A.R.	0.18%
13	BALANCE F.A.R. FROM E.M.S.	0.67%
14	PROPOSED NO. OF FLOOR	B+S+16
15	PROPOSED NO. OF UNITS	464
16	PROPOSED BUILDING HEIGHT	51.00MT.
17	PROPOSED GREEN AREA	24.22%
18	PROPOSED BASEMENT AREA	16788.3
19	PROPOSED NO. OF CAR PARKING	502

AREA STATEMENT		
SNO.	PARTICULARS	SQ.MTR./NOS.
1	TOTAL PLOT AREA	14500.40
2	PERMISSIBLE GROUND COVERAGE	50%
3	PERMISSIBLE F.A.R.	2.9%
4	PERMISSIBLE DENSITY	870
5	PERMISSIBLE HEIGHT	N.A.
6	PERMISSIBLE GREEN AREA	15%
7	PERMISSIBLE PARKING AREA	1216.05 SQM
8	PROPOSED GROUND COVERAGE	41.24%
9	PROPOSED F.A.R.	1.58%
10	PROPOSED NO. OF FLOOR	G+3, S/G+4
11	PROPOSED NO. OF UNITS	608
12	PROPOSED BUILDING HEIGHT	14.2MT.
13	PROPOSED GREEN AREA	18.48%
14	PROPOSED PARKING AREA	1288.67

F.A.R AREA STATEMENT			
AREA TABLE OF F.A.R.		GROUP HOUSING	
SNO.	FLOORS	F.A.R.	NO. OF DWELLING UNITS
1	F.A.R AREA ON 1st FL.	2493.62	29
2	F.A.R AREA ON 2nd FL.	2493.62	29
3	F.A.R AREA ON 3rd FL.	2493.62	29
4	F.A.R AREA ON 4th FL.	2493.62	29
5	F.A.R AREA ON 5th FL.	2493.62	29
6	F.A.R AREA ON 6th FL.	2493.62	29
7	F.A.R AREA ON 7th FL.	2493.62	29
8	F.A.R AREA ON 8th FL.	2493.62	29
9	F.A.R AREA ON 9th FL.	2493.62	29
10	F.A.R AREA ON 10th FL.	2493.62	29
11	F.A.R AREA ON 11th FL.	2493.62	29
12	F.A.R AREA ON 12th FL.	2493.62	29
13	F.A.R AREA ON 13th FL.	2493.62	29
14	F.A.R AREA ON 14th FL.	2493.62	29
15	F.A.R AREA ON 15th FL.	2493.62	29
16	F.A.R AREA ON 16th FL.	2493.62	29
17	F.A.R AREA ON TERRACE FL.	36897.920	464
18	F.A.R AREA ON TERRACE FL.	36897.920	464
TOTAL	TOTAL F.A.R AREA	36897.920	464
TOTAL	TOTAL NO. OF UNIT	464	

F.A.R AREA STATEMENT FOR EMS (01,02,05 & 06)									
AREA TABLE OF F.A.R.		EMS 01		EMS 02		EMS 05		EMS 06	
SNO.	FLOORS	F.A.R	NO. OF DWELLING UNITS	F.A.R	NO. OF DWELLING UNITS	F.A.R	NO. OF DWELLING UNITS	F.A.R	NO. OF DWELLING UNITS
1	F.A.R AREA ON GROUND FL.	904.05	24	904.05	24	904.05	24	904.05	24
2	F.A.R AREA ON 1st FL.	904.05	24	904.05	24	904.05	24	904.05	24
3	F.A.R AREA ON 2nd FL.	904.05	24	904.05	24	904.05	24	904.05	24
4	F.A.R AREA ON 3rd FL.	904.05	24	904.05	24	904.05	24	904.05	24
5	F.A.R AREA ON 4th FL.	904.05	24	904.05	24	904.05	24	904.05	24
6	F.A.R AREA ON TERRACE FL.	3616.24	96	3616.24	96	3616.24	96	3616.24	96
TOTAL	TOTAL F.A.R AREA	14664.96	384						
TOTAL	TOTAL NO. OF UNIT	384							

F.A.R AREA STATEMENT FOR EMS (03)									
AREA TABLE OF F.A.R.		EMS 03							
SNO.	FLOORS	F.A.R	NO. OF DWELLING UNITS						
1	F.A.R AREA ON GROUND FL.	1044.76	28						
2	F.A.R AREA ON 1st FL.	1044.76	28						
3	F.A.R AREA ON 2nd FL.	1044.76	28						
4	F.A.R AREA ON 3rd FL.	1044.76	28						
5	F.A.R AREA ON TERRACE FL.	4793.04	112						
TOTAL	TOTAL F.A.R AREA	4793.04	112						
TOTAL	TOTAL NO. OF UNIT	112							

F.A.R AREA STATEMENT FOR EMS (04)									
AREA TABLE OF F.A.R.		EMS 04							
SNO.	FLOORS	F.A.R	NO. OF DWELLING UNITS						
1	F.A.R AREA ON GROUND FL.	627.57	14						
2	F.A.R AREA ON 1st FL.	1044.76	28						
3	F.A.R AREA ON 2nd FL.	1044.76	28						
4	F.A.R AREA ON 3rd FL.	1044.76	28						
5	F.A.R AREA ON 4th FL.	627.57	14						
TOTAL	TOTAL F.A.R AREA	4890.02	112						
TOTAL	TOTAL NO. OF UNIT	112							

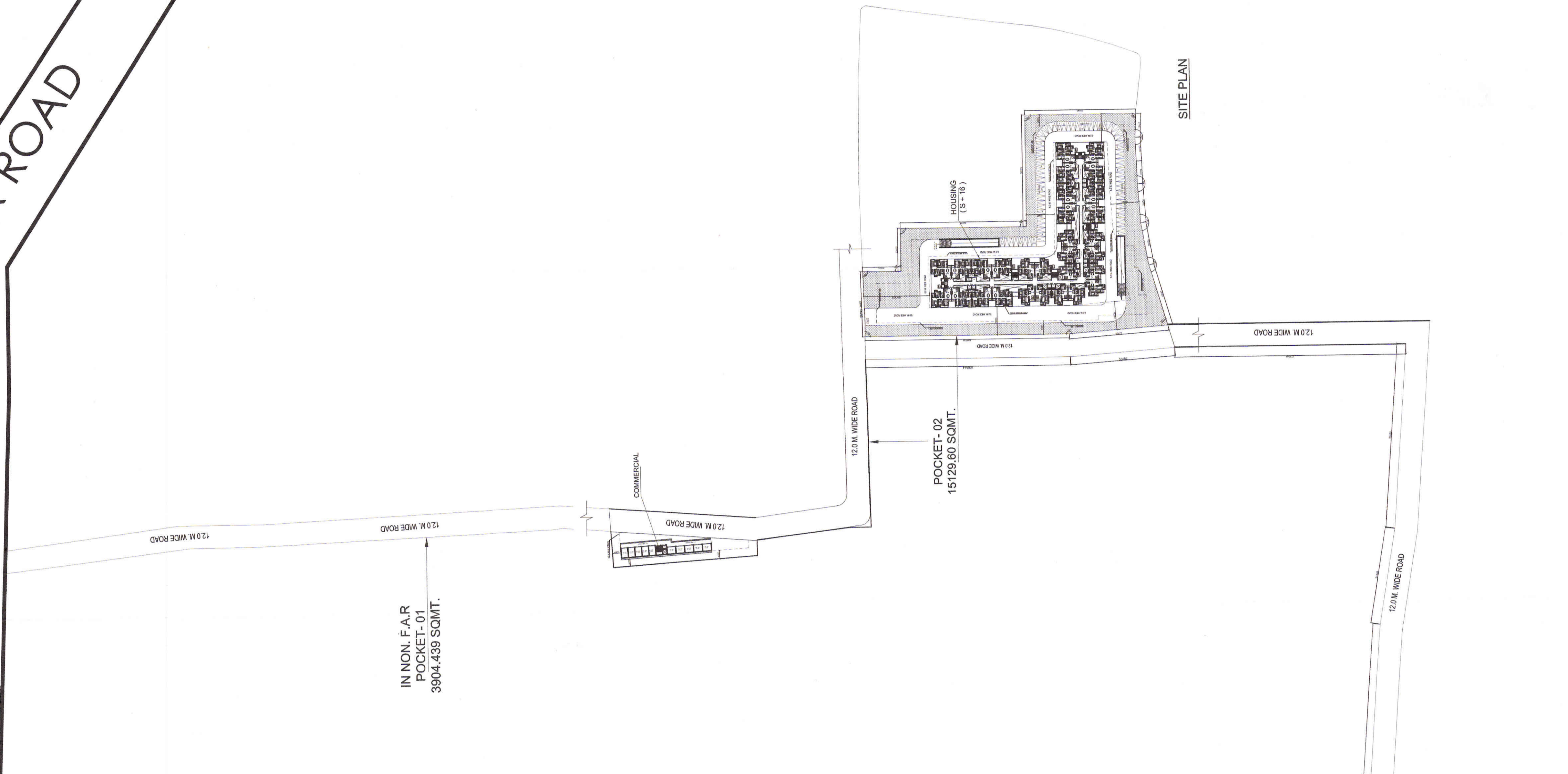

1. Where ever 60 per cent of the plot area is to be developed...
 2. The building height shall not exceed...
 3. The building shall be constructed...
 4. The building shall be constructed...
 5. The building shall be constructed...
 6. The building shall be constructed...
 7. The building shall be constructed...
 8. The building shall be constructed...
 9. The building shall be constructed...
 10. The building shall be constructed...
 11. The building shall be constructed...
 12. The building shall be constructed...
 13. The building shall be constructed...
 14. The building shall be constructed...
 15. The building shall be constructed...
 16. The building shall be constructed...
 17. The building shall be constructed...
 18. The building shall be constructed...
 19. The building shall be constructed...
 20. The building shall be constructed...

DES ARC
 ARCHITECTS, INTERIORS, PLANNING
 UGSR - 1A, ANSAL PLAZA, SECTOR - I, VAISHALI, GZB
 PH: 0120 - 4253114 M: 0-9818711273
 EMAIL- desarc14@gmail.com

PROPOSED AFFORDABLE HOUSING " SAI CITY "
 UNDER " P. M. A. Y. " AT DASEPUR, VARANASI
 FOR MIS : SHREE SAI BABA INFRA PROJECTS PVT. LTD.

DRAWING TITLE
SITE PLAN

DRAWING TYPE
SITE PLAN

DRG. NO.
PMAY- 01/001

Shree Sai Baba Infra Projects (P) Ltd.
 Director